



## RESIDENTIAL FENCES



Community Development Department  
 Current Planning Division  
 111 East Maple  
 Independence, MO 64050

**City of Independence**  
 Community Development Department  
 Current Planning Division  
 111 East Maple  
 Independence, MO 64050  
 (816) 325-7425  
[www.independencemo.org](http://www.independencemo.org)

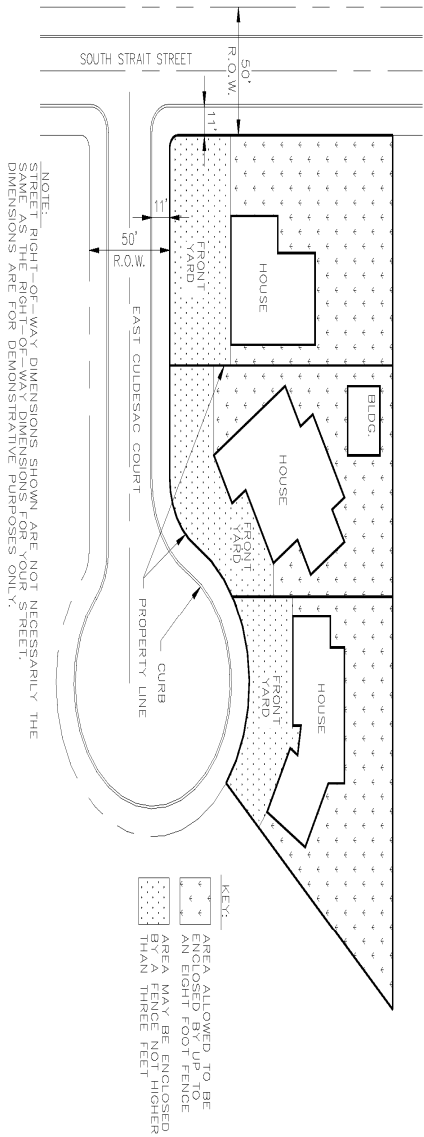

## Residential Fences

### Do I need a permit to construct a fence?

Yes, if the fence exceeds 6 feet in height. Permits are not required for fences that are less than 6 feet in height.



### How high can a fence be?

A fence cannot exceed 8 feet height, except fences around tennis courts, swimming pools and other similar recreational facilities. Fences in front of a residence and along a street side in front of the residence shall not exceed 36-inches in height and be at least 50% transparent such as a chain link, picket, wrought iron, and split rail fencing.



### Where can a fence be located?

A fence may be constructed up to the property line. It is the property owner's responsibility for accurately determining the location of the property lines. (Note: The curb/edge of pavement of the street is not your property line.) Additionally, a fence cannot be located within 25 feet of an extended point of intersection of street rights-of-way.

### What materials can be used?

A fence shall be made of normal fencing materials such as synthetic wood, plastic (vinyl or PVC), chain link, wood, wrought iron, etc. Temporary plastic construction fencing, plywood, canvas, metal sheets, or similar materials are not permitted for use as permanent fencing. No more than 2 different types of fencing materials shall be used.

### What are the design guidelines?

All fences must be constructed with a finished side facing outward from the property. The posts and support beams must be on the inside or must be designed as part of the finished surface. The material's color must be similar to that of traditional wood fencing; bright colors such as bright orange, red, etc. are not permitted. Barbed wire and electrified fences are not permitted unless used in a bonafide farming activity.



### Do I need to maintain my fence?

Yes, all fences must be maintained in a reasonable condition and vertical position, and any missing or deteriorated slats, pickets, other fencing material, or structural elements must be replaced in a timely manner with the same quality of material and workmanship.

### For more information about residential fences contact:

#### Community Development Department

- Fence requirements for new/extended fences – please call 816-325-7425
- Fence permits—please call 816-325-7401
- Fence violations—please call 816-325-7193 option 5



**!!!CALL BEFORE YOU DIG!!! 1-800-DIG-RITE (1-800-344-7483)**